

New Product Announcement

3/3/2014

[Edition 2,]

QUICK CONNECT VACUUM INTERFACE UNIT

Patented Quick Connect Vacuum Interface Compatible with FLEX TC and MAX TC Systems, for rapid replacement of devices in Sockets, during multiple testing.

Mechanical Devices is introducing the Quick Connect Vacuum Interface enabling quick replacement of devices in the sockets and is suitable for operators who plan on testing many devices on a daily basis conveniently. Adjust the vacuum force to apply the exact closing force on the DUT according to the socket manufacturer requirements.

Using the vacuum quick connect is Easy, Convenience, Safe, accurate, with secured alignment and allows replacement of hundreds of devices easily with fast test set-ups.

Meets the most demanding cycle time requirements with 100% device continuity at the test sockets.

- Adjustable DUT pressure force (0 -14 Kg/ Force).
- Ultra-quiet operation (40dBA)
- Small footprint, high reliability design.
- Ease of use during set-up & operation



Quick Connect Vacuum Mechanism comes in 3 different types:

1. D1 – 100mm/up to 4.8Kg
2. D1 – 140mm/up to 9.6Kg
3. D1 – 160mm/up to 13.9Kg

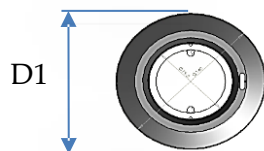

Three Vacuum Components Features

...

Quick Connect Vacuum Generation Unit P/N - VGU485



- **System Enclosure (mm/inch):**
140(L) x140(W)x 63.5 (H)
5.5(L) x 5.5(W) x 2.5(H)
- **Fluid admitted – compressed Air**
- **Service pressure range:**
87-130 psi (0.6-0.9Mpa)
- **Vacuum level: -26.5 in.Hg (-90 kPa;0.9Bar)**

Quick connect P/N QCV485-30



- 100/140/160mm deep cyclone vacuum pad.
- Vacuum hose m/(ft):
1.0meter (3.25ft)
- DUT pressure force:
0-14Kg/ Force.

Vacuum Adapter plate P/N – VBA485-30



- Custom designed to match customer specified test socket/board
- Peek base with round edge aluminium plate.